

01N series

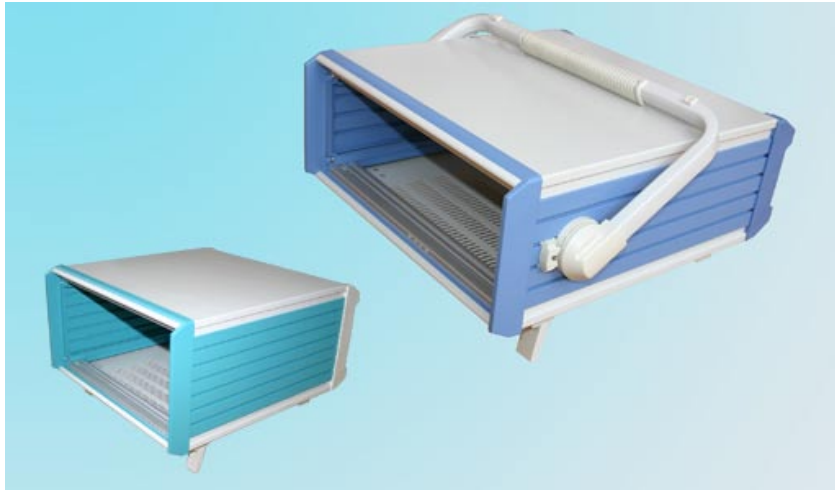

- Aluminum construction
- Top and bottom cover spaired plastic
- simple assembly
- Custom colors available
- Wide range of enclosure size
- Special assembly services

Height/Width Chart

| Exterior size | | | | Interior size | | Panel size | | Panel mounting size | |
|-------------------|------------------|----------------|---------------|---------------|--------------|------------------------|-----------------------|---------------------|------------|
| Side plate Height | Rail length (HP) | Overall Height | Overall width | Inside Height | Inside Width | Front panel blank size | Rear panel blank size | Front panel | Rear panel |
| HS | | H | L | h | l | B×A | D×C | m | n |
| 2U | 42 | 112 | 257 | 68 | 218 | 240.5×85 | 215×85 | 78 | 78 |
| 2U | 63 | 112 | 364 | 68 | 325.5 | 347.5×85 | 322.5×85 | 78 | 78 |
| 3U | 42 | 157 | 256 | 113 | 218 | 240.5×130 | 215×130 | 123 | 123 |
| 3U | 63 | 157 | 364 | 113 | 326 | 347.5×1130 | 324×130 | 123 | 123 |
| 3U | 84 | 157 | 469 | 113 | 431.5 | 453×130 | 428.5×130 | 123 | 123 |
| 4U | 63 | 201 | 364 | 157 | 326 | 347.5×174 | 324×174 | 167 | 167 |
| 4U | 84 | 201 | 469 | 157 | 431.5 | 453×174 | 428.5×174 | 167 | 167 |

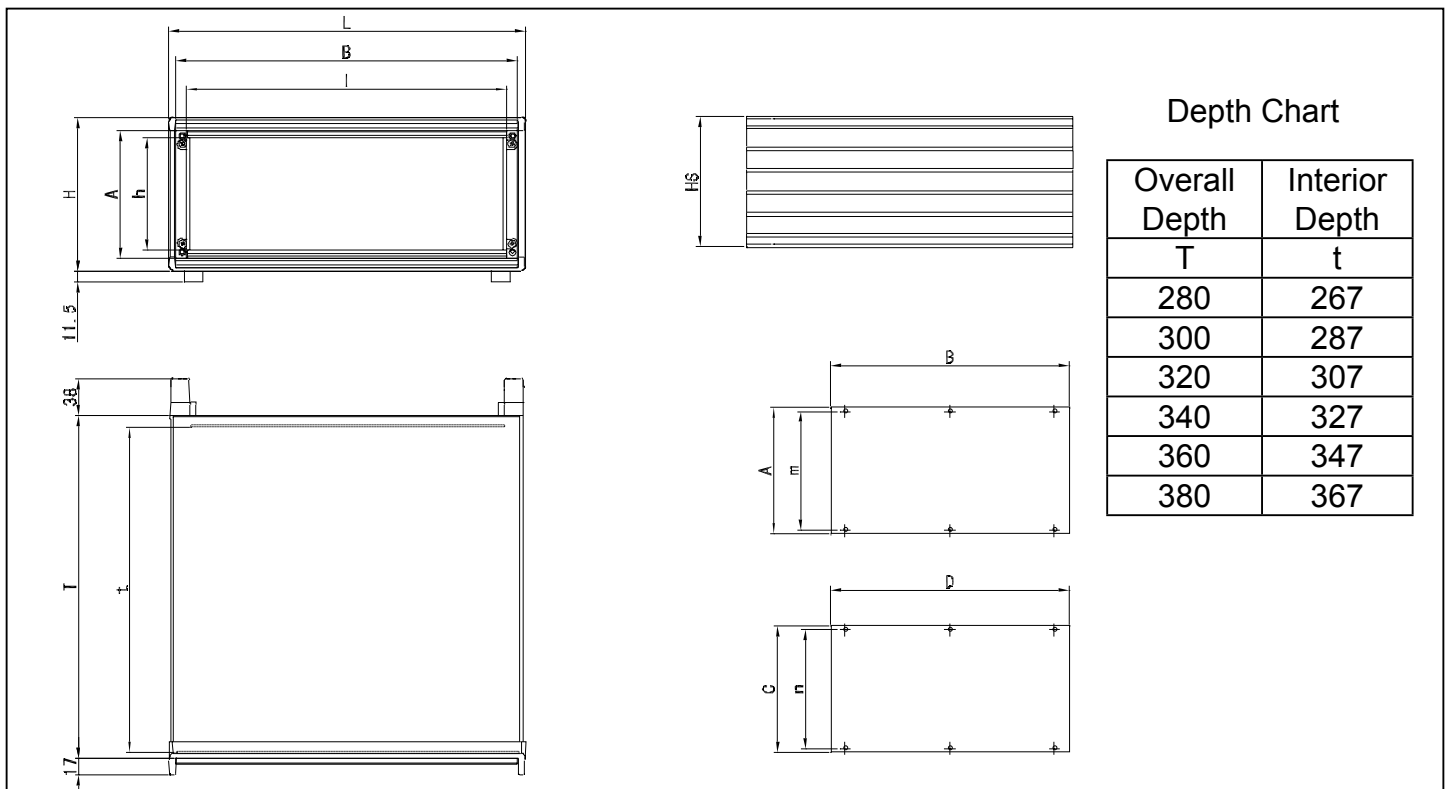

Standard configuration

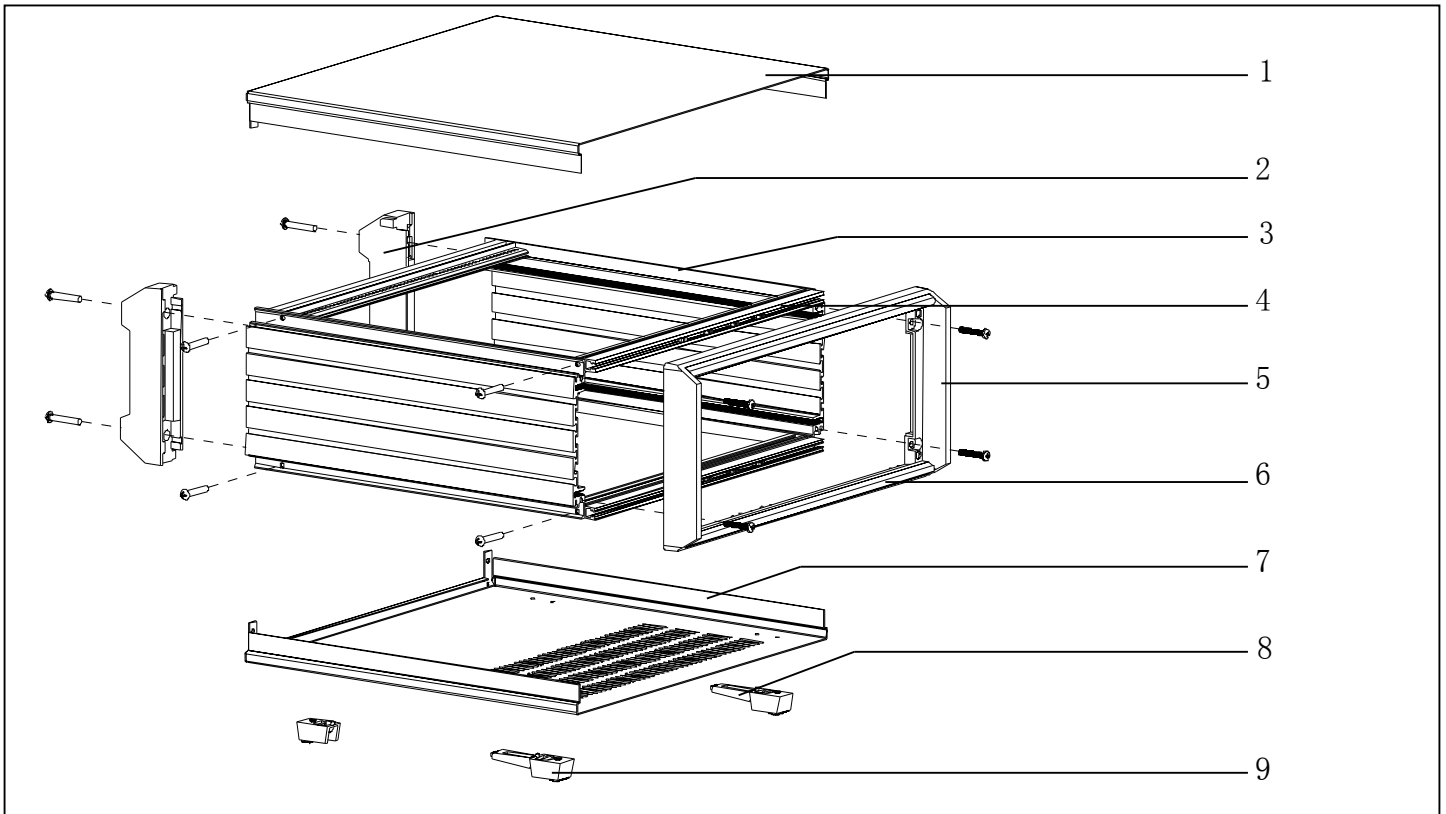

| ITEM | PART | QTY | DESCRIPTION |
|------|----------------|-----|--|
| 1 | Top cover | 1 | Aluminium sheet,spary plastic |
| 2 | Rear foot | 2 | Moulded in rubber-plastic |
| 3 | Side panel | 2 | Aluminium extrusion |
| 4 | Rail | 4 | Aluminium extrusion,pre-punched holes for card guide |
| 5 | Frame | 1 | Diecast aluminium,spary plastic |
| 6 | Decorative bar | 2 | Aluminium extrusion,spary plastic |
| 7 | Bottom cover | 1 | Aluminium sheet,spary plastic |
| 8 | Support foot | 2 | Moulded in PC |
| 9 | Bottom foot | 4 | Moulded in PC |

Extrusions

Rail

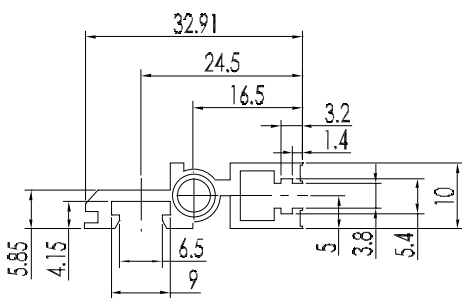

| Length table | | | |
|--------------|-----|-----|-----|
| HP | 42 | 63 | 84 |
| Length(mm) | 218 | 325 | 432 |

- Material: Aluminum extrusion
- Clear anodized
- Pre-punched holes for card guide

Side plate

- Material: Aluminum extrusion
- Clear anodized
- Optional depth
- Spary plastic

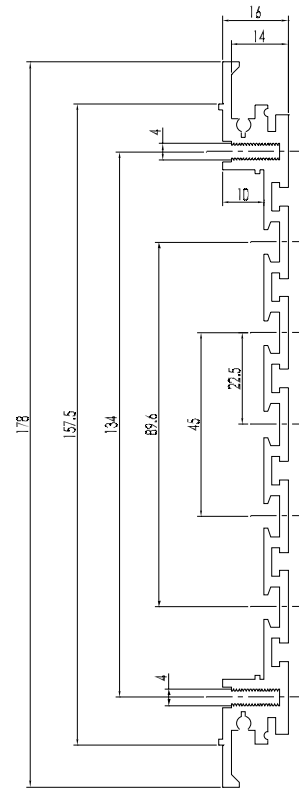
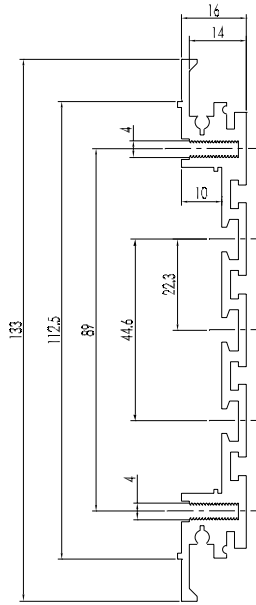
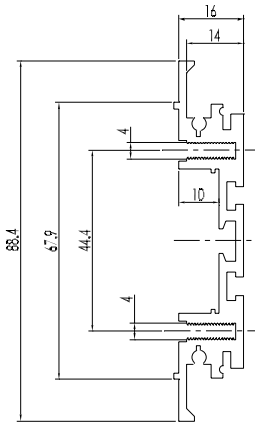

Decorative bar

- Material: Aluminum extrusion
- spary plastic

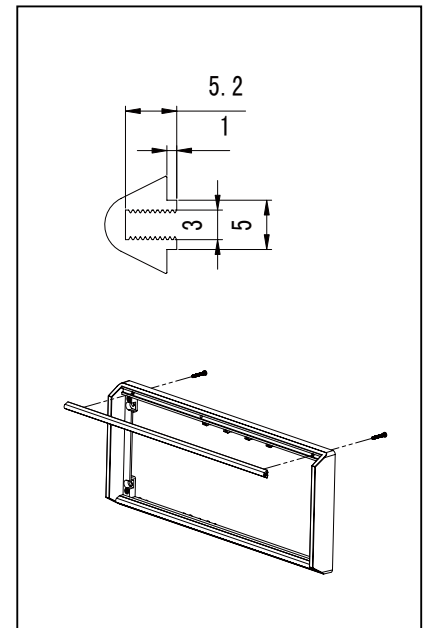

Optional Accessories

Plug Bar

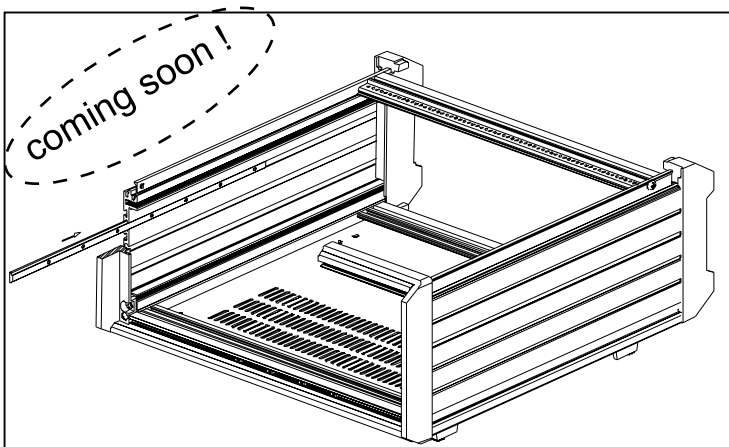

- Material: Aluminum extrusion
- Clear anodized

Side Mounting Plate

- Material: 1mm Aluminum sheet

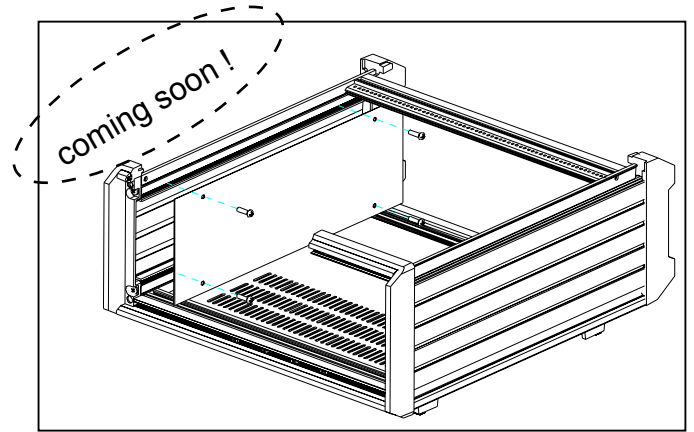

Bottom Mounting Plate

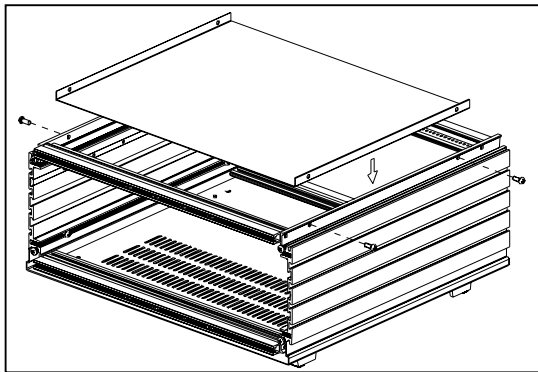

- Material: 1.5mm or 2mm Aluminum sheet
- Choices of two style (style A and style B)
- Fixing onto front rail and rear rail for style A
- Fixing onto two side plate for style B

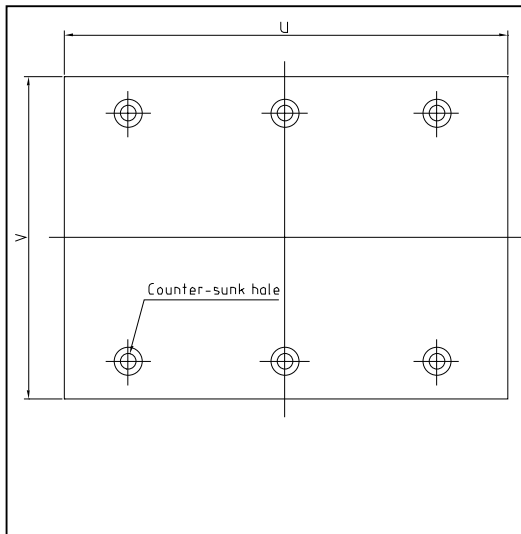

Style A

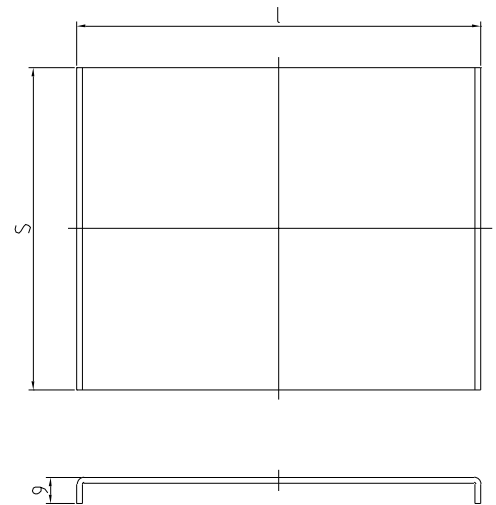

Style B

Dimensions chart

Chart 1 (For style A) $u(\text{mm}) \times v(\text{mm})$

| Width T | 42HP | 63HP | 84HP |
|------------|---------|-----------|-----------|
| 180mm | 215×163 | 322.5×163 | 428.5×163 |
| 240mm | 215×223 | 322.5×223 | 428.5×223 |
| 300mm | 215×283 | 322.5×283 | 428.5×283 |
| 320mm | 215×303 | 322.5×303 | 428.5×303 |
| 360mm | 215×343 | 322.5×343 | 428.5×343 |

Chart 2 (For style B) $l(\text{mm}) \times s(\text{mm})$

| Width T | 42HP | 63HP | 84HP |
|------------|---------|-----------|-----------|
| 180mm | 211×114 | 318.5×114 | 424.5×114 |
| 240mm | 211×174 | 318.5×174 | 424.5×174 |
| 300mm | 211×234 | 318.5×234 | 424.5×234 |
| 320mm | 211×254 | 318.5×254 | 424.5×254 |
| 360mm | 211×294 | 318.5×294 | 424.5×294 |

Card guide

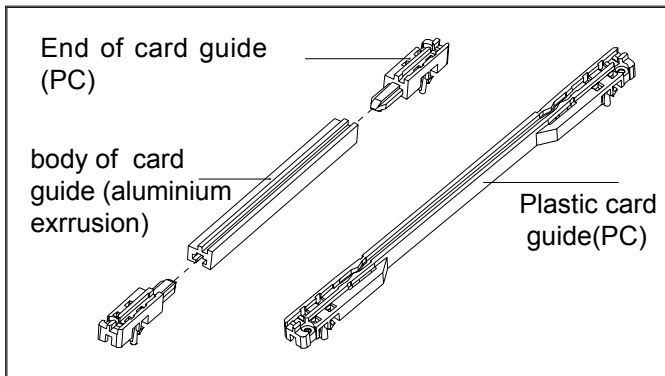
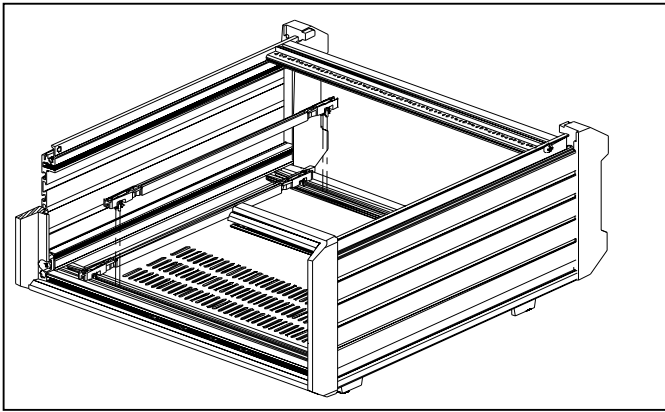

| Length of plastic card guide | | |
|------------------------------|-----|-----|
| LC(mm) | 143 | 210 |
| LH(mm) | 123 | 183 |

| Height of PCB | | | |
|---------------|----|-------|-----|
| H | 2U | 3U | 4U |
| P(mm) | 56 | 100.5 | 145 |

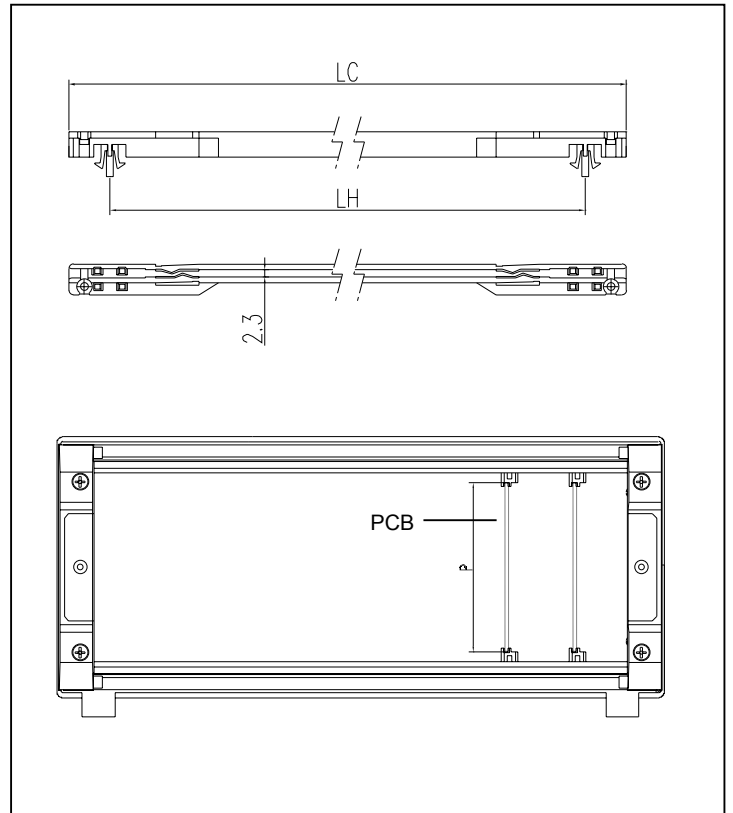

- Choices of two style of card guide (plastic or alimium extrusion)
- moulded in PC for plastic card guide
- Optional length for aluminum extrusions card guide
- Suitable for 1.6mm to 2.0mm nominal thickness
- Custom colors available

Panel of plug-in unit

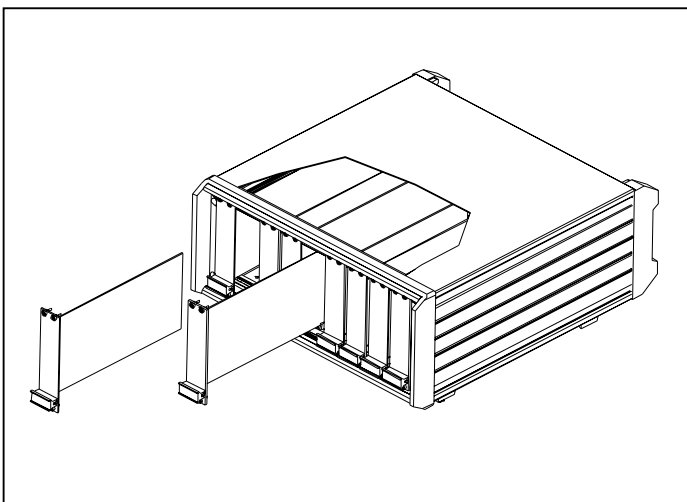

- Material :2mm alminium sheet ,Clear anodized
- Quick locks screw into the slide nuts plugged in front rail or rear rail
- With "V" drag
- Optional size of panel, also cut-outs in the panel available on request
- The dimension in the below ,A-40, show the fixing points for PCB's vertical space

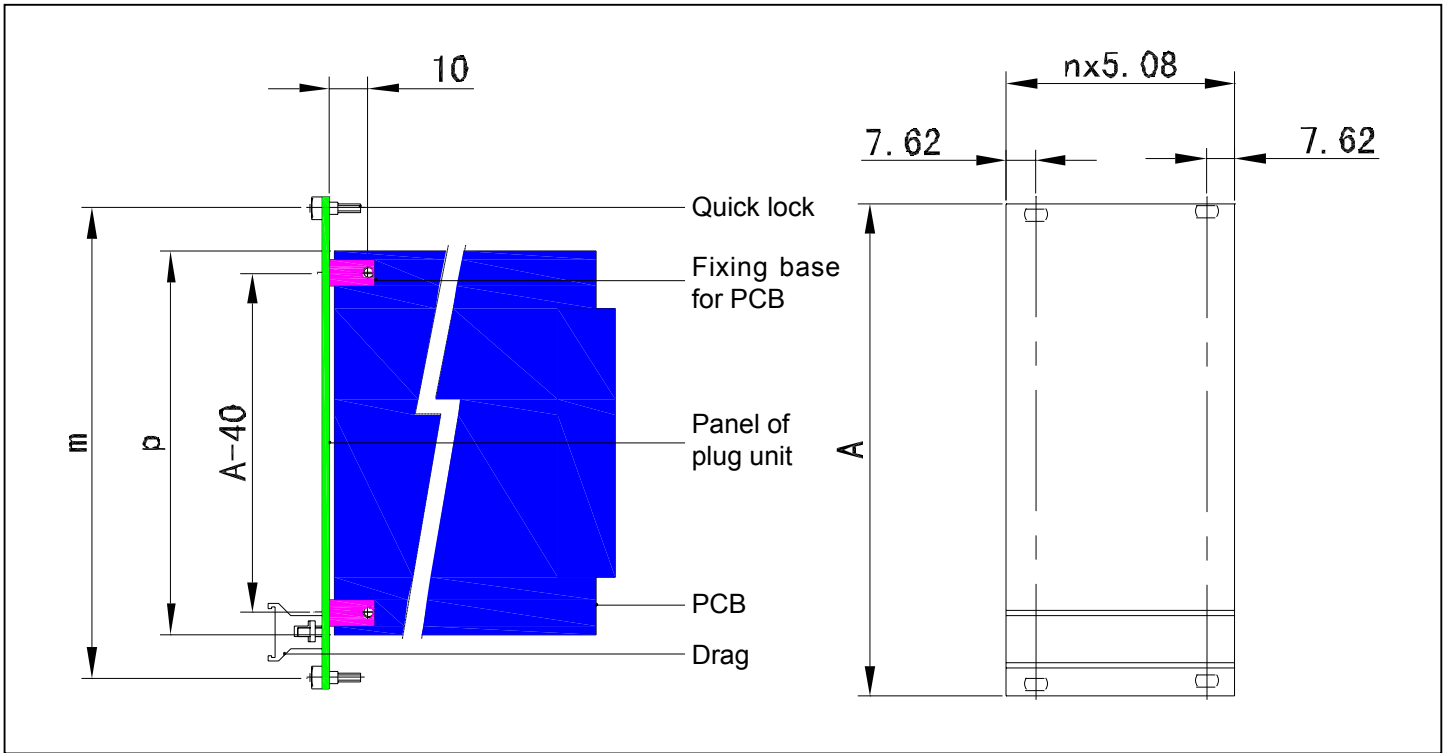

Box of plug-in unit

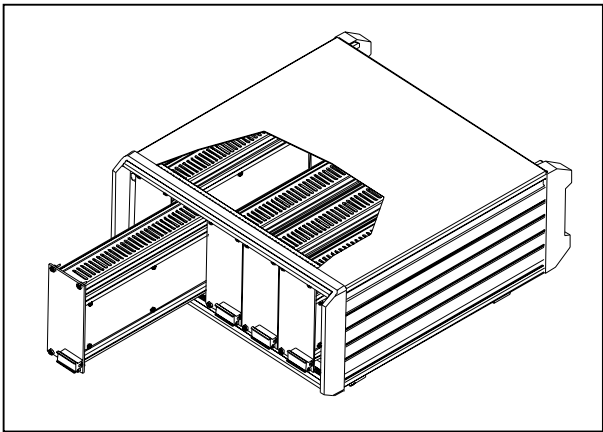

Dimensions chart for box

| H | 2U | 3U | 4U | 5U | 6U |
|--------|----|----|----|----|----|
| HB(mm) | | | | | |

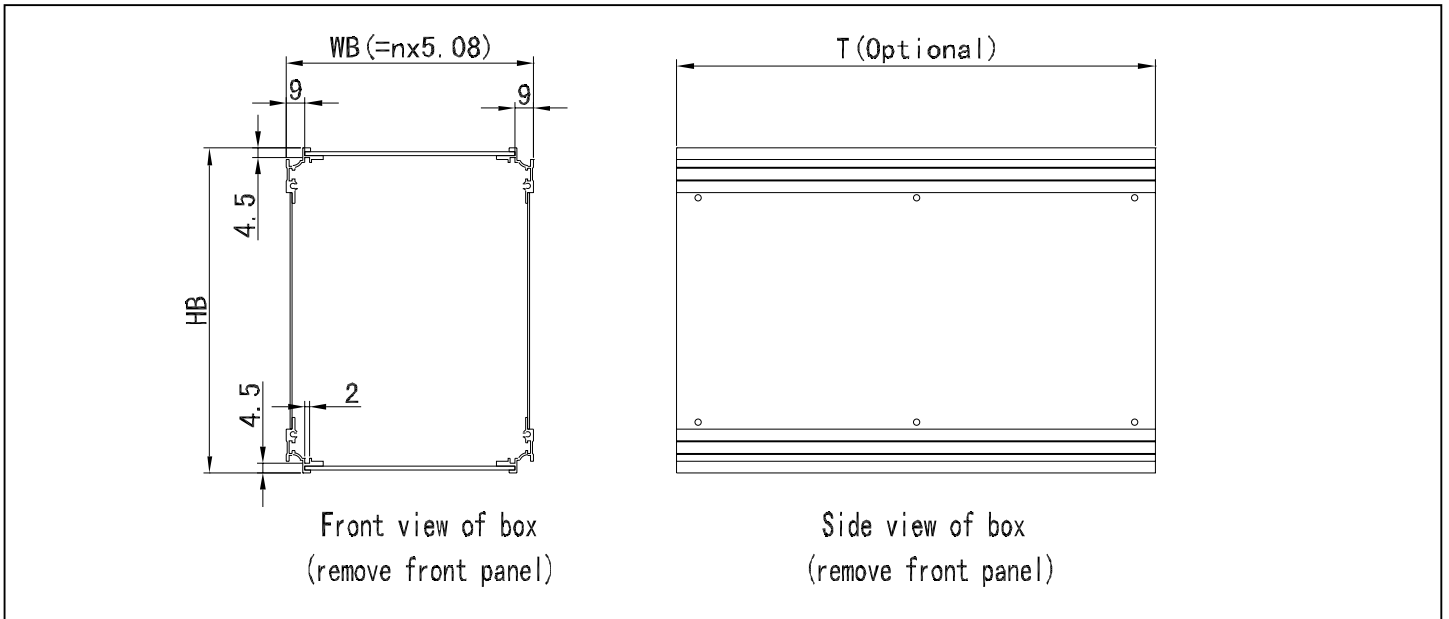

Mid-Rail

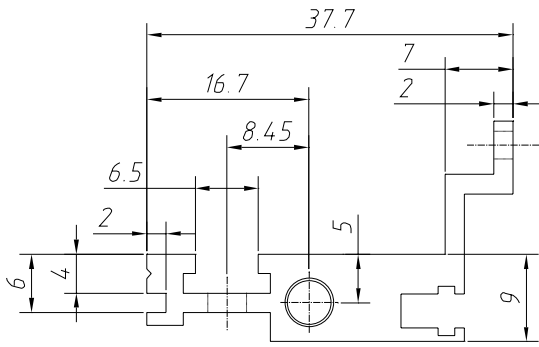

| Length table | | | |
|--------------|-----|-----|-----|
| HP | 42 | 63 | 84 |
| Length(mm) | 218 | 325 | 432 |

- Material: Aluminum extrusion
- Clear anodized
- With or without pre-punched holes for card guide available
- suitable for installation of backplanes

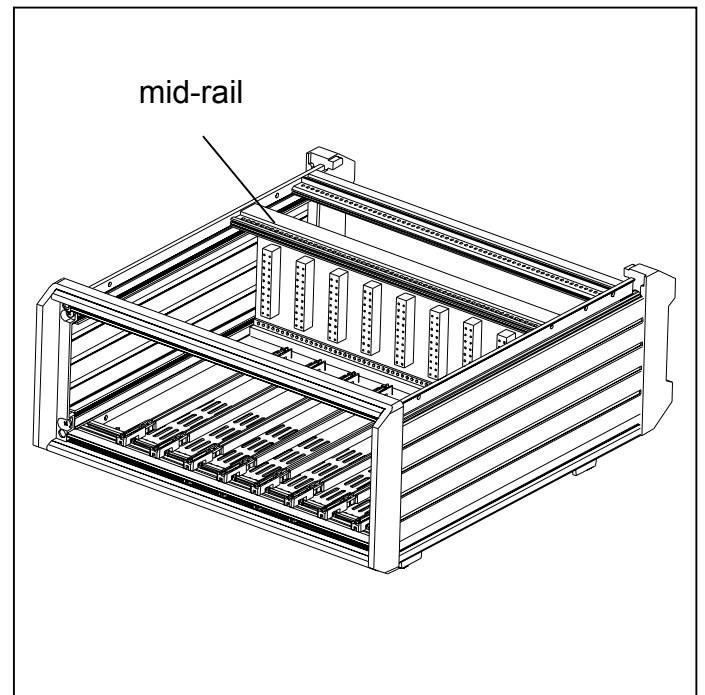
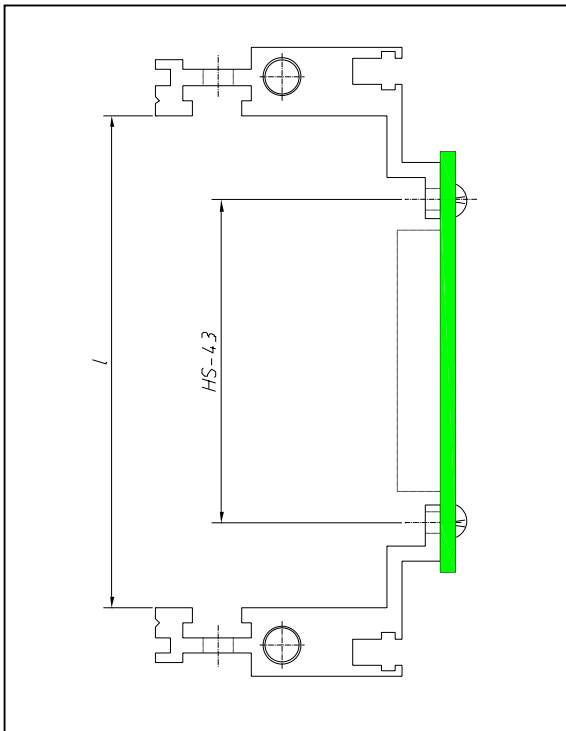

Panel

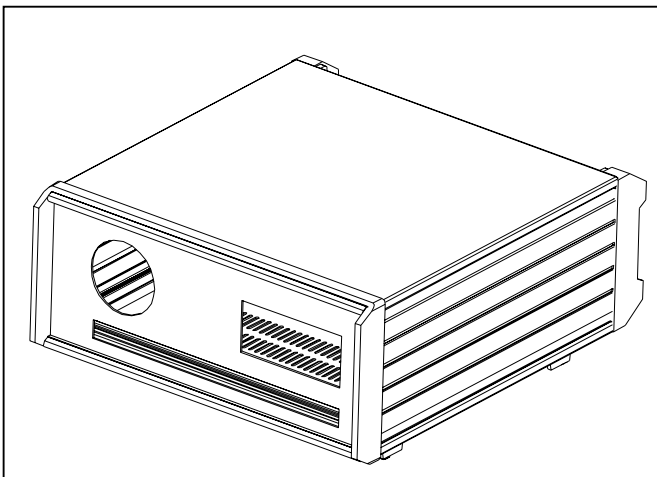

- Material: 2mm Aluminum sheet
- Clear anodized available
- Refer to page 1 for the dimensions of front and rear panel
- Cut-outs in the front and rear panel available

Threaded insert

- Material: Stainless steel
- With threaded holes (pitch of 5.08mm)
- Replacement of slide nuts as standard version
- For mounting front or rear panel

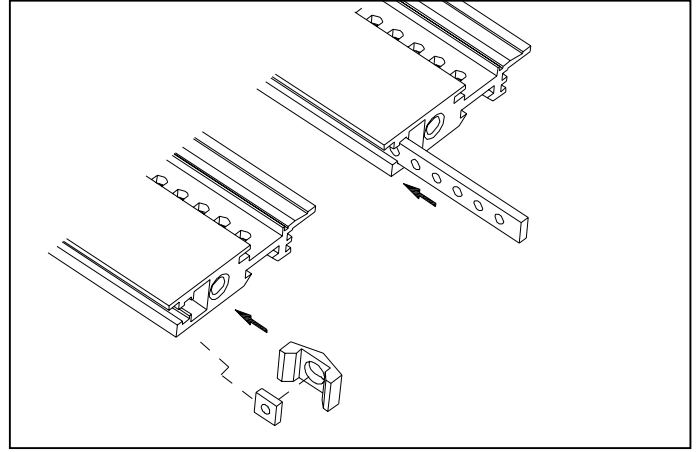

Bottom feet

- Material: PC
- Choices of four style
- Style A as standard version

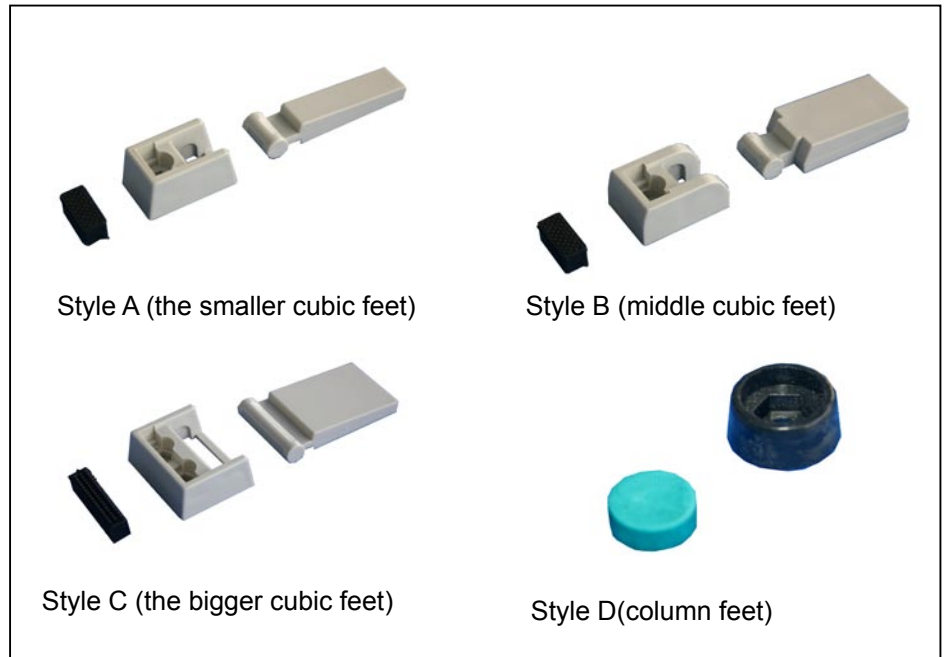
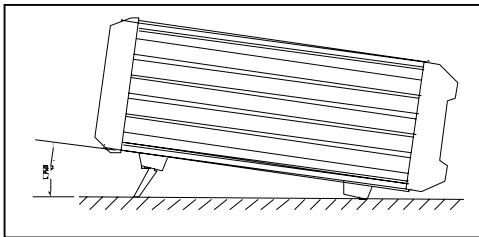

Handle



Model: T1

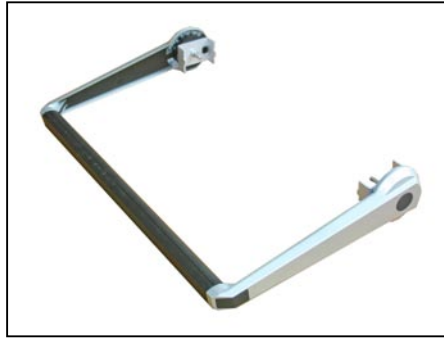

Model: T2



Model: T5



Model: T6

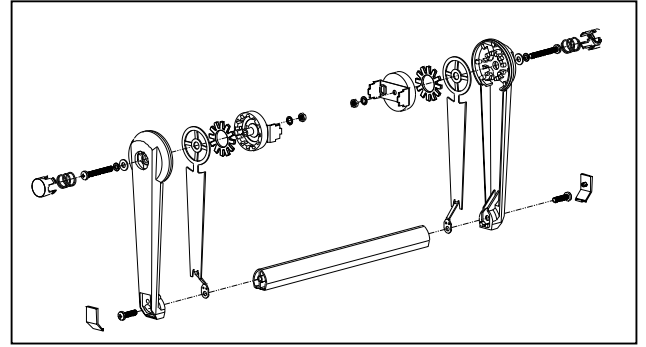

Explode view for T1 or T2

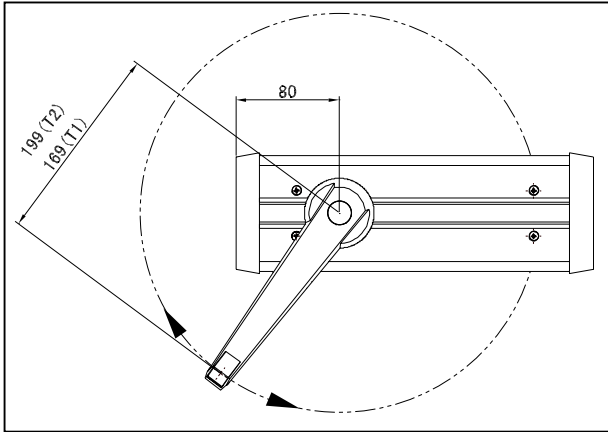

- Choice of four models of handle
- Can be revolved about the axis as left drawing every other 30 degree
- Bearing capability of 30kg
- T5 as the standard version

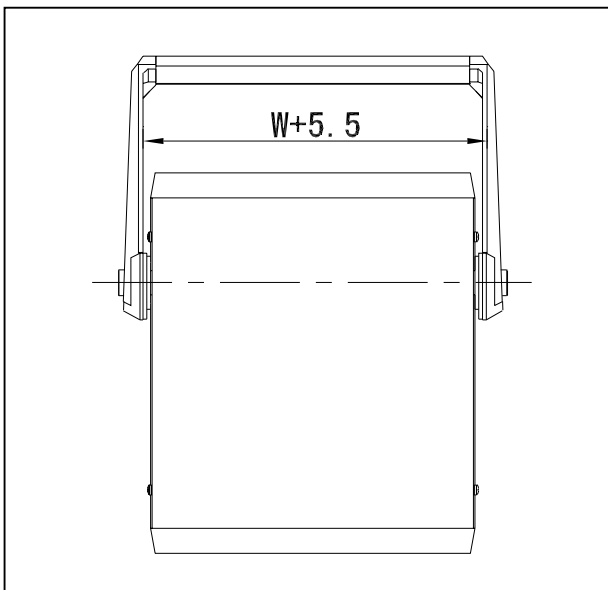

How to order

It is very simple ordering 01N series enclosures of Changhe
Just pick up the phone and call your local Changhe office (View our web site <http://www.enclosures.com.cn> to get the address of Changhe enclosures, also dial us at 86-574-63028237)

- inform us the model of your enclosure to order
- Inform us the desired overall height(H), overall width(W) and depth(T)
* see the chart on page 1 for definitions of H, W and T
- Optional accessories should be separately ordered
- You must specify the model of handle
- Specify us your desired color of enclosure
*see our website to view various of colors configuration
- You should send us the drawing if you require secondary tooling or other cut-outs

Example : Model:01D

case size: 3U×42HP×300mm

handle: T6

colors: case 2

Accessories: 20 pieces of 210mm plastic card guide



长河机箱

Ningbo Dayang enclosures Co., Ltd.

Economic development zone, changchizhi

Road, Cixi city, Zhejiang province, China

Tel: 86-574-63028237

Fax: 86-574-63028372

Website:<http://www.enclosures.com.cn>